

## ChainSafe

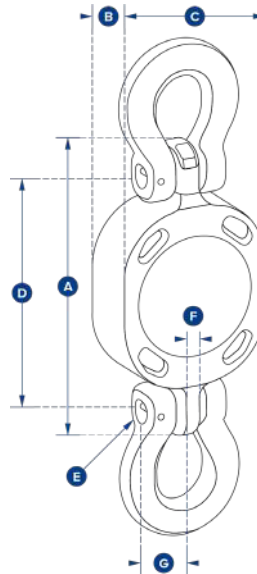

- Designed to work with 10mm chain.
- Unmatched weight-to-strength ratio.
- Update rate of 1Hz and the Bluetooth signal effortlessly connects to any iOS or Android smartphone that has our free HHP App that will alert the operator on their smartphone if any overload is occurring.
- Bluetooth wireless range of 100m/328ft.
- No battery change required.
- Battery life 5 yrs based on 3 hrs use per day.
- Environmentally sealed to IP67/NEMA6.
- Internal antenna.
- Conforms to EN1677:2008.
- Fatigue tested to 30,000 cycles to 1.5x WLL.

| Part Numbers SP      | ChainSafe                                  |
|----------------------|--|
| Crosby               | 2789536                                    |
| Capacity             | 4 t  |
|                      | 88000 lb                                   |
| Resolution           | 0.002 t                                    |
|                      | 4 lb                                       |
| Weight               | 2.5 kg                                     |
|                      | 5.5 lb                                     |
| Design Factor        | 4:1  |
| Battery Type         | Lithium Thionyl Chloride (non replaceable) |
| Battery Life         | 5 years based on 3 hours use per day       |
| Operating Temp.      | -10°C to +50°C / 14°F to 122°F             |
| Accuracy             | +/- 0.2% of full scale                     |
| Range                | 100 meters / 328 feet                      |
| Data Range           | 1 Hz                                       |
| Protection           | IP67 / NEMA6                               |
| Dimension A          | 164 mm                                     |
|                      | 6.46"                                      |
| Dimension B          | 35 mm                                      |
|                      | 1.38"                                      |
| Dimension C          | 85 mm                                      |
|                      | 3.35"                                      |
| Dimension D          | 132 mm                                     |
|                      | 5.20"                                      |
| Dimension E          | 13.2 mm                                    |
|                      | 0.52"                                      |
| Dimension F          | 11 mm                                      |
|                      | 0.43"                                      |
| Dimension G          | 28 mm                                      |
|                      | 1.10"                                      |
| Recommended Fittings | 3/8" (10mm) G100 Chain fittings            |

ChainSafe is designed to be fitted with an array of The Crosby Group's chain fittings, and is an approved wireless tension loadcell capable of load monitoring of capacities up to 4t.

### Grab Hooks:



### Chain shortener:



### Links:



### Lashing:



### Links:



### Connectors:



chain fittings are not included