

Bolt On Line Tensionmeter (BOLT)

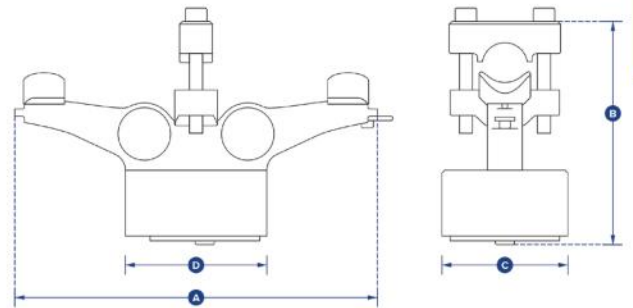

2

- Constructed from aerospace-grade aluminum.
- Designed to be mounted in a permanent position on wire rope or cable to accurately monitor measurements of tension up to 10,000 kg or 20,000lb and up to 32mm or 1.25in diameter.
- Proprietary 2.4 GHz wireless.
- Leading wireless range of 1000m/3280ft when connected to SW-HHP, enabling you to read up to four loadcells simultaneously.
- Unlimited range when connected to BaseStation to monitor remotely.
- Will provide reduced site visits, improve decision making and safely monitor line tensions from any distance from anywhere in the world.
- Unrivalled battery life of 1200 hrs.
- Multiple drop tested from 3 meters or 10 feet.
- Internal antenna.
- Remote on/off from handheld display or software.

Part Numbers	BOLT10T
SP	
Crosby	2789573
Max Load	10 t
	22000 lb
Resolution	0.01 t
	20 lb
Units	kilograms, pounds, metric tons and kilonewtons
Min Wire Rope Ø	16 mm
	5/8"
Max Wire Rope Ø	32 mm
	1 1/4"
Weight	2.1 kg
	4.6 lb
Battery Type	4 x 'AA' cell batteries
Battery Life	1200 hours
Operating Temp.	-10°C to +50°C / 14°F to +122°F
Protection	IP67 / NEMA6
Accuracy	Typically 3-5%
Communication	2.4 GHz
Dimension A	259 mm
	10.20"
Dimension B	159.1 mm
	6.26"
Dimension C	89 mm
	3.50"



CROSBY STRAIGHTPOINT TRAINING VIDEOS

- How to pair a loadcell (and multiple loadcells) to a handheld
- How to know the correct number of compression cells required
- How to use the backlight function on a handheld
- How to get accurate loadcell readings at various distances
- Snatch block & loadcell demonstration
- COLT calibration verification tool installation demo
- Plus many more...

Watch now at thecrosbygroup.com/SPvideos