

SNATCH BLOCK WITH HOOK FITTING, SINGLE SHEAVE, 2-12t



416

L-170

L-160

C-720

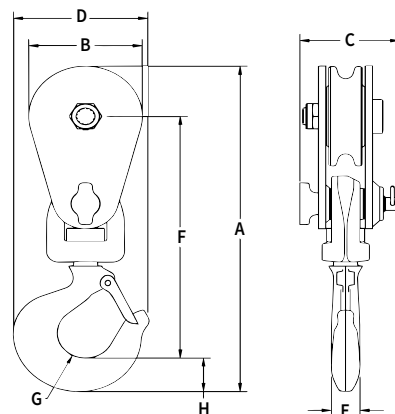

- Opening feature permits easy insertion of rope without reeving, or while the block is suspended.
- Bolt for opening feature is retained, to ensure no lost bolts.
- Forged steel swivel tees, yokes and hooks.
- Furnished with a latch installed.
- Can be furnished with bronze bushings or roller bearings.
- Center pin equipped with pressure lube fitting.
- All sizes feature sheave grooves suited for a range of wireline diameters.
- Meets or exceeds all requirements of ASME B30.26. Importantly, these blocks meet other critical performance requirements including fatigue life and material traceability, not addressed by ASME B30.26.
- 416 alloy snatch blocks feature a significant reduction in weight compared to snatch blocks made of non-alloy materials.
- L-170 snatch blocks (with shackle or hook) feature an easy-to-open bolt design. The retaining bolt is released by rotating the fitting assembly, no tools required.
- Crosby's Engineered Solutions Group is ready to discuss your requirements and help select or develop the ideal block for your application.
- Visit thecrosbygroup.com/engineeredolutions for more information.



APPLICATION AND WARNING INFORMATION SECTION 17

Working Load Limit (t)	Wire Rope Diameter (mm)	Sheave Diameter (mm)	Bearing Code	Weight Each (kg)	Catalog No.	Stock No.	Dimensions (mm)							
							A	B	C	D	E	F	G	H
2 metric tons														
2	8 - 10	76	BB	2.3	418	108038	247	76	67	91	19	184	19	25
4 metric tons														
4	10 - 13	114	BB	5.4	418	108065	359	108	79	133	25	257	24	47
5 metric tons														
5	10 - 13 ‡	102	BB	5.0	L-170	599800	371	116	75	133	25	267	24	47
5	10 - 13 ‡	102	RB	5.0	L-170	599819	371	116	75	133	25	267	24	47
6 metric tons														
6*	10 - 13	127	BB	5.9	L-160	599506	370	130	94	133	25	257	24	47
6*	10 - 13	127	RB	5.9	L-160	599515	370	130	94	133	25	257	24	47
7 short Tons														
7T*	19 - 22	6	BB	12.7	C-720	280010	410	152	97	159	37	288	32	41
8 metric tons														
8	16 - 19	152	BB	12.2	418	108127	481	152	106	173	40	344	33	61
8	16 - 19	152	RB	12.2	418	108154	481	152	106	173	40	344	33	61
8	16 - 19	203	BB	15.0	418	108225	534	206	106	173	40	369	33	61
8	16 - 19	203	RB	15.0	418	108252	534	206	106	173	40	369	33	61
8	16 - 19	254	BB	18.6	418	108323	586	257	106	173	40	396	33	61
8	16 - 19	254	RB	18.6	418	108350	586	257	106	173	40	396	33	61
8	16 - 19	305	BB	21.8	418	108421	658	308	106	173	40	442	33	61
8	16 - 19	305	RB	21.8	418	108458	658	308	106	173	40	442	33	61
8	16 - 19	356	BB	24.9	418	108528	696	359	106	173	40	455	33	61
8	16 - 19	356	RB	24.9	418	108546	696	359	106	173	40	455	33	61
12 metric tons														
12*	16 - 19	146	BB	13.2	L-160	599560	508	152	106	200	40	365	37	67
12*	16 - 19	146	RB	13.2	L-160	599579	508	152	106	200	40	365	37	67
12	19 - 22	152	BB	11.8	416	193427	505	152	106	200	40	362	37	67
12	19 - 22	152	RB	11.8	416	193472	505	152	106	200	40	362	37	67
12	19 - 22	203	BB	15.0	416	193490	558	206	106	200	40	388	37	67
12	19 - 22	203	RB	15.0	416	193542	558	206	106	200	40	388	37	67
12	19 - 22	254	BB	18.6	416	193613	610	257	106	200	40	415	37	67
12	19 - 22	254	RB	18.6	416	193677	610	257	106	200	40	415	37	67

4:1 Design Factor. *3.5:1 Design Factor.. ‡ Special Dual Groove Sheave also accepts 32mm Manila Rope