



S-377

- Forged carbon steel, Quenched & Tempered.
- The resultant load on each hook cannot exceed 0.5t.
- Meets the performance requirements of Federal Specification RR-C-271G, Type V, Class 6, except for those provisions required of the contractor.



S-377 Barrel Hooks

Working Load Limit Per Pair (t)	Stock No. Per Pair	Weight Each Per Pair (kg)	Dimensions (mm)			
			I.D. of Eye	O.D. of Eye	Overall Length	Width of Lip
1.0	1028248	1.61	39.6	71.4	127	73.2

4:1 Design Factor.



S-3316

- Easily attaches to any chain and electric hoist with welded link load chain, roller chain or wire rope with suitable end fitting.
- Swivel jaw is forged.
- Suitable for positioning before lifting.

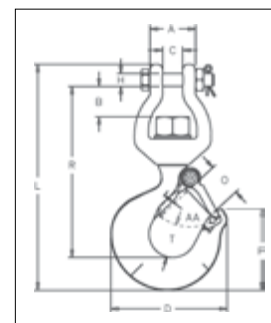

APPLICATION AND WARNING INFORMATION SECTION 17



S-3316 Replacement Hook

Working Load Limit (t)	Frame Code	Stock No.	Weight Each (kg)	Dimensions (mm)												Replacement Latch Kit Stock No.
				A	B	C	D	H	L	O	P	R	T	AA		
.5	F	1023029	.57	33.5	17.8	14.2	80.0	9.7	159	24.4	56.4	120	25.1	50.8	1096374	
1	H	1023047	1.18	33.5	25.4	17.0	101	11.2	197	29.5	70.6	150	29.5	50.8	1096468	

5:1 Design Factor.



A-378

- Forged alloy steel, Quenched & Tempered.
- Deep straight throat permits efficient handling of flat plates or large cylindrical shapes.



A-378 with Handle

A-378 Sorting Hook



Working Load Limit at tip of Hook (t)	Working Load Limit at bottom of Hook (t)	Stock No	Style	Weight Each (kg)	Dimensions (mm)			
					I.D. of Eye	Overall Length	Opening at top of Hook	Radius at bottom of Hook
1.8	6.8	1028024	No Handle	2.91	35.0	246	71.4	15.9
1.8	6.8	1028033	With Handle	2.91	35.0	246	71.4	15.9

4:1 Design Factor.