

O-318

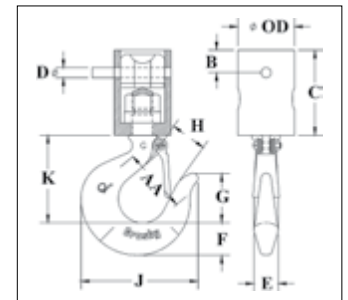

- With ball bearing swivel; attaches to chain by an alloy pin.
- Suitable for frequent rotation under load.
- O-318 Hooks utilize Crosby SHUR-LOC® positive locking hooks. Latch is self-locking when hook is loaded.
- O-319 Hooks utilize Crosby® standard 319 Shank Hooks which incorporate QUIC-CHECK® deformation and angle indicators. (For detailed information, see the Crosby Value Added page at the beginning of this section.)
- Entire assembly is zinc plated.
- Repair kit available consisting of bearing and spring pin.

O-319

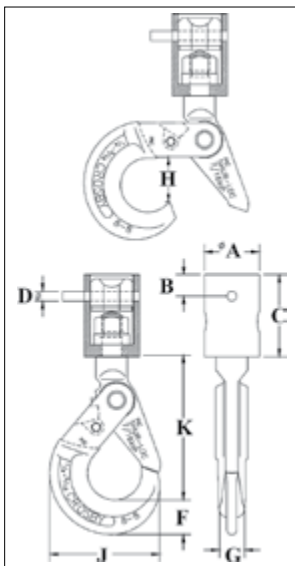

APPLICATION AND WARNING INFORMATION
SECTION 17

O-318 Chain Nest Hooks

Chain Size (mm)	Stock No.	Working Load Limit (t)	Weight Each (kg)	Dimensions (mm)								
				A	B	C	D	F	G	H	J	K
6 - 7	1098409	1.5	1.59	44.5	17.8	66.5	7.87	27.9	20.6	37.1	89.0	117
8 - 10	1098427	2.1	2.72	54.0	17.8	81.0	9.65	29.2	23.9	46.5	110	144
10 - 11	1098445	3.8	6.24	76.0	25.4	111	12.7	42.2	29.5	53.5	138	179
13 - 14	1098463	3.8	6.24	76.0	25.4	111	16.0	42.2	29.5	53.5	138	179

4:1 Design Factor.

O-319 Chain Nest Hooks

Chain Size (mm)	Stock No.	Working Load Limit (t)	Weight Each (kg)	Dimensions (mm)										
				OD	AA	B	C	D	E	F	G	H	J	K
6 - 7	1098312	1.5	1.16	44.5	51.0	17.8	66.5	7.87	19.1	25.4	38.9	25.4	92.0	68.5
8 - 10	1098334	2.1	1.81	54.0	51.0	17.8	81.0	9.65	21.3	28.4	43.7	28.4	104	77.5
10 - 11	1098356	3.8	4.54	76.0	63.5	25.4	111	12.7	28.4	36.6	54.0	34.0	123	96.0
13 - 14	1098378	3.8	4.54	76.0	63.5	25.4	111	16.0	28.4	36.6	54.0	34.0	123	96.0

4:1 Design Factor. *Deformation indicators.