

# SNATCH BLOCK WITH SHACKLE FITTING, SINGLE SHEAVE, 15-60t



421

419

431

435

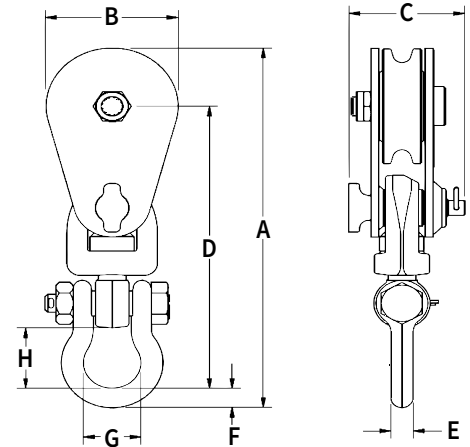

- Opening feature permits easy insertion of rope without reeving, or while the block is suspended.
- Can be furnished with bronze bushings or roller bearings.
- Center pin equipped with pressure lube fitting.
- All sizes feature sheave grooves suited for a range of wireline diameters.
- Meets or exceeds all requirements of ASME B30.26. Importantly, these blocks meet other critical performance requirements including fatigue life and material traceability, not addressed by ASME B30.26.
- 435 alloy snatch blocks feature a significant reduction in weight compared to snatch blocks made of non-alloy materials.
- Crosby's Engineered Solutions Group is ready to discuss your requirements and help select or develop the ideal block for your application. Visit [thecrosbygroup.com/engineeredolutions](http://thecrosbygroup.com/engineeredolutions) for more information.



APPLICATION AND WARNING INFORMATION SECTION 17

Working Load Limit (t)	Wire Rope Diameter (in)	Sheave Diameter (in)	Bearing Code	Weight Each (lb)	Catalog No.	Stock No.	Dimensions (in)							
							A	B	C	D	E	F	G	H
<b>15 metric tons</b>														
15	3/4 - 7/8	8	BB	59	421	108308	23.00	8.12	5.09	17.19	1.50	1.75	3.12	3.12
15	3/4 - 7/8	8	RB	59	421	108309	23.00	8.12	5.09	17.19	1.50	1.75	3.12	3.12
15	3/4 - 7/8	10	BB	68	421	108390	24.75	10.12	5.09	17.94	1.50	1.75	3.12	3.12
15	3/4 - 7/8	10	RB	68	421	108391	24.75	10.12	5.09	17.94	1.50	1.75	3.12	3.12
15	3/4 - 7/8	16	BB	130	419	109607	31.75	16.12	5.09	22.00	1.50	1.75	3.12	3.12
15	3/4 - 7/8	16	RB	130	419	109625	31.75	16.12	5.09	22.00	1.50	1.75	3.12	3.12
15	7/8 - 1	18	BB	159	419	109643	33.12	18.12	5.09	22.25	1.50	1.75	3.12	3.12
15	7/8 - 1	18	RB	159	419	109661	33.12	18.12	5.09	22.25	1.50	1.75	3.12	3.12
<b>20 metric tons</b>														
20	1 - 1-1/8	8	BB	92	431	121022	26.57	8.12	6.00	19.76	2.00	2.75	3.72	4.00
20	1 - 1-1/8	8	RB	92	431	121040	26.57	8.12	6.00	19.76	2.00	2.75	3.72	4.00
20	1 - 1-1/8	10	BB	112	431	121095	28.64	10.12	6.00	20.72	2.00	2.75	3.72	4.00
20	1 - 1-1/8	10	RB	112	431	121111	28.64	10.12	6.00	20.72	2.00	2.75	3.72	4.00
20	1 - 1-1/8	12	BB	130	431	121175	30.65	12.25	6.00	21.78	2.00	2.75	3.72	4.00
20	1 - 1-1/8	12	RB	130	431	121193	30.65	12.25	6.00	21.78	2.00	2.75	3.72	4.00
20	1 - 1-1/8	14	BB	160	431	121255	33.00	14.00	6.00	23.25	2.00	2.75	3.72	4.00
20	1 - 1-1/8	14	RB	160	431	121273	33.00	14.00	6.00	23.25	2.00	2.75	3.72	4.00
<b>25 metric tons</b>														
25	1 - 1-1/4	8	BB	103	435	208954	27.08	8.25	6.13	20.21	2.00	2.75	3.72	4.00
25	1 - 1-1/4	10	BB	117	435	208965	29.33	10.24	6.13	21.46	2.00	2.75	3.72	4.00
25	1 - 1-1/4	18	BB	270	431	119495	41.36	18.25	7.13	29.12	2.00	3.12	3.50	4.81
25	1 - 1-1/4	18	RB	280	431	119496	41.36	18.25	7.13	29.12	2.00	3.12	3.50	4.81
<b>30 metric tons</b>														
30	1 - 1-1/4	12	BB	208	435	208976	36.61	12.25	7.00	27.37	2.00	3.12	3.50	4.81
30	1 - 1-1/4	14	BB	230	435	208977	38.86	14.25	7.00	28.62	2.00	3.12	3.50	4.81
30	1 - 1-1/4	20	BB	503	431	119589	52.40	20.25	8.31	38.34	2.50	3.94	5.62	7.06
30	1 - 1-1/4	20	RB	485	431	119598	52.40	20.25	8.31	38.34	2.50	3.94	5.62	7.06
30	1 - 1-1/4	24	BB	581	431	119605	56.00	24.25	8.31	40.00	2.50	3.94	5.62	7.06
30	1 - 1-1/4	24	RB	575	431	119614	56.00	24.25	8.31	40.00	2.50	3.94	5.62	7.06
<b>60 metric tons</b>														
60	1 - 1-1/4	12	BB	315	435	8027291	41.65	12.12	8.66	33.19	2.06	2.40	5.75	6.12

15

4:1 Design Factor.