

**G-2130A**  
Grade 8

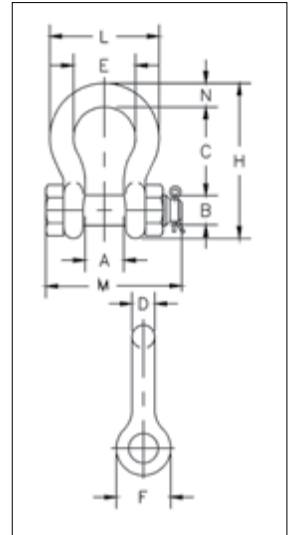

- Forged alloy steel, Quenched & Tempered, with bow and bolt.
- Meets or exceeds all requirements of Grade 8 shackles.
- Working Load Limit permanently shown on every shackle.
- Hot-dip galvanized.
- Meets or exceeds all requirements of ASME B30.26, including identification, ductility, design factor, proof load, and temperature requirements. Importantly, G-2130A meet other critical performance requirements, including impact properties, and material traceability not addressed by ASME B30.26.
- Shackles can be furnished proof tested with certificates to designated standards, such as ABS, DNV, Lloyds, or other certification when requested at time of order.
- Type Approval and certification in accordance with DNV 2.7-1 offshore containers.
- Shackles are Quenched & Tempered and meet DNV impact requirements of 42 Joules (31 ft-lb) at -40° C (-40° F).
- G-2130A Bolt Type Anchor shackles with thin head bolt – nut with cotter pin. Meets the performance requirements of Federal Specification RR-C-271H, Type IVA, Grade B, Class 3, except for those provisions required of the contractor.



### G-2130A Alloy Bolt Type Anchor Shackles Grade 8

Nominal Size (in)	Working Load Limit (t)*	Stock No.	Weight Each (lb)	Dimensions (in)										Tolerance (+ / - in)	
				A	B	C	D	E	F	H	L	M	N	C	A
1/2	2	1219472	.79	.81	.63	1.88	0.50	1.31	1.19	3.29	2.30	2.80	0.50	0.13	0.06
5/8	3.25	1219491	1.37	1.06	.75	2.38	0.63	1.69	1.50	4.18	2.94	3.56	0.69	0.25	0.06
3/4	4.75	1219516	2.71	1.25	.88	2.82	0.75	2.01	1.81	4.96	3.51	4.15	0.81	0.25	0.06
7/8	6.5	1219534	3.95	1.44	1.00	3.31	0.88	2.29	2.09	5.83	4.02	4.82	0.97	0.25	0.06
1	8.5	1219552	5.03	1.69	1.10	3.76	1.00	2.70	2.38	6.58	4.69	5.39	1.06	0.25	0.06
1-1/8	9.5	1219578	8.27	1.81	1.25	4.26	1.13	2.92	2.70	7.49	5.16	5.90	1.25	0.25	0.06
1-1/4	12	1219598	11.7	2.03	1.38	4.69	1.25	3.25	2.99	8.27	5.75	6.69	1.38	0.25	0.06
1-3/8	13.5	1219614	15.8	2.25	1.50	5.24	1.38	3.62	3.31	9.18	6.38	7.21	1.50	0.25	0.13
1-1/2	17	1219632	19.0	2.38	1.63	5.75	1.50	3.88	3.62	10.0	6.90	7.73	1.62	0.25	0.13

8:1 Design Factor. Maximum Proof Load is 2 times the Working Load Limit. For Working Load Limit reduction due to side loading applications, see Warnings & Applications..

