

**IPTK**



**IPTKW**

## For transferring steel beams and attaching tackle eye

- Available in capacities of 2 through 25 metric tons (higher Working Load Limits are available upon request).
- Wide variety of jaw openings available: 2.95" to 40.16".
- Welded alloy steel body for strength and smaller size. Forged alloy components, where required.
- Individually Proof Tested to 2 times the Working Load Limit with certification.
- Company name (Crosby IP), logo, Working Load Limit and jaw opening permanently stamped on body.
- Each product is individually serialized, with the serial number and Proof Load test date stamped on body. User manual with test certificate is included with each clamp.
- Maintenance and repair kits are available.

**IPTKU**



**IPTKUM**

*Load Tested*

**IPTK:** with hoisting eye / **IPTKW:** without hoisting eye

**IPTKU:** with hinged hoisting eye / **IPTKUD:** with double locking device

**IPTKUM:** Suitable as anchor device for personnel fall arrest equipment

| Model   | Working Load Limit (t)* | Stock No. | Weight Each (lb) | Dimensions (in) |           |       |      |      |      |      |      |  |
|---|-------------------------|-----------|------------------|-----------------|-----------|-------|------|------|------|------|------|--|
|   |                         |           |                  | Jaw A           | C         | D     | E    | F    | H    | J    | K    |  |
| IPTK  | 2                       | 2700996   | 13.2             | 2.95 - 7.48     | A + 3.13  | 4.92  | 2.95 | -    | 0.98 | -    | 0.79 |  |
| IPTK  | 3                       | 2700997   | 14.3             | 2.95 - 7.48     | A + 3.13  | 4.92  | 2.95 | -    | 0.98 | -    | 0.79 |  |
| IPTK  | 4                       | 2700998   | 18.7             | 5.91 - 11.02    | A + 4.00  | 4.92  | 2.95 | -    | 1.38 | -    | 0.79 |  |
| IPTK  | 5                       | 2700994   | 24.3             | 4.72 - 13.78    | A + 7.67  | 4.92  | 2.95 | -    | 1.57 | -    | 0.79 |  |
| IPTK  | 25                      | 2702999   | 496.0            | 17.72 - 40.16   | A + 8.66  | 19.69 | 4.92 | -    | 2.99 | -    | 1.77 |  |
| <b>Without Hoisting Eye</b>   |                         |           |                  |                 |           |       |      |      |      |      |      |  |
| IPTKW   | 2                       | 2700966   | 8.82             | 3.00 - 7.50     | A + 3.13  | 4.92  | -    | 1.10 | 0.98 | -    | -    |  |
| IPTKW   | 3                       | 2700967   | 9.92             | 3.00 - 7.50     | A + 3.13  | 4.92  | -    | 1.10 | 0.98 | -    | -    |  |
| IPTKW   | 4                       | 2700968   | 13.9             | 5.88 - 11.25    | A + 4.00  | 4.92  | -    | 1.30 | 1.38 | -    | -    |  |
| IPTKW   | 5                       | 2700969   | 19.4             | 4.75 - 13.75    | A + 7.67  | 4.92  | -    | 1.30 | 1.57 | -    | -    |  |
| <b>With Improved Hinged Hoisting Eye</b>  |                         |           |                  |                 |           |       |      |      |      |      |      |  |
| IPTKU   | 2                       | 2707996   | 12.6             | 3.00 - 7.50     | A + 3.94  | 6.50  | 2.99 | 0.87 | 0.87 | 3.90 | 0.75 |  |
| IPTKU   | 3                       | 2707997   | 14.1             | 3.00 - 7.50     | A + 3.94  | 6.50  | 3.50 | 0.87 | 0.87 | 4.80 | 0.87 |  |
| IPTKU   | 4                       | 2707998   | 26.7             | 4.75 - 11.25    | A + 5.91  | 7.28  | 3.50 | 1.57 | 1.57 | 4.80 | 0.87 |  |
| IPTKU   | 5                       | 2707994   | 32.0             | 4.75 - 13.75    | A + 6.89  | 7.28  | 3.50 | 1.57 | 1.57 | 4.80 | 0.87 |  |
| IPTKU   | 10                      | 2707970   | 90.4             | 7.88 - 18.00    | A + 11.81 | 8.46  | 4.13 | 2.36 | 2.36 | 5.98 | 1.02 |  |
| <b>Suitable as anchor device for personnel fall arrest equipment - standard according to EN 795</b> |                         |           |                  |                 |           |       |      |      |      |      |      |  |
| IPTKUM  | 1 person                | 2709991   | 13.2             | 3.00 - 7.50     | A + 3.94  | 6.50  | 2.99 | -    | 0.87 | 3.90 | 0.75 |  |
| <b>With Optional Double Locking Device</b>  |                         |           |                  |                 |           |       |      |      |      |      |      |  |
| IPTKUD  | 2                       | 2709996   | 13.2             | 3.00 - 7.50     | A + 3.94  | 6.50  | 2.99 | 0.87 | 0.87 | 3.90 | 0.75 |  |
| IPTKUD  | 3                       | 2709993   | 14.6             | 3.00 - 7.50     | A + 3.94  | 6.50  | 3.50 | 0.87 | 0.87 | 4.80 | 0.87 |  |
| IPTKUD  | 4                       | 2709995   | 27.1             | 4.75 - 11.25    | A + 5.91  | 7.28  | 3.50 | 1.57 | 1.57 | 4.80 | 0.87 |  |
| IPTKUD  | 5                       | 2709994   | 33.7             | 4.75 - 13.75    | A + 6.89  | 7.28  | 3.50 | 1.57 | 1.57 | 4.80 | 0.87 |  |
| IPTKUD  | 10                      | 2709970   | 94.8             | 7.88 - 18.00    | A + 11.81 | 8.46  | 4.13 | 2.36 | 2.36 | 5.98 | 1.02 |  |

\* Design Factor based on EN 13155 and ASME B30.20.

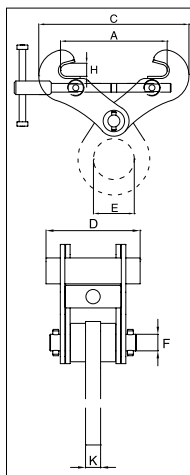

**IPTK/IPTKW**

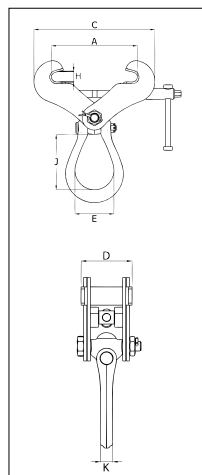

**IPTKU(D)(M)**

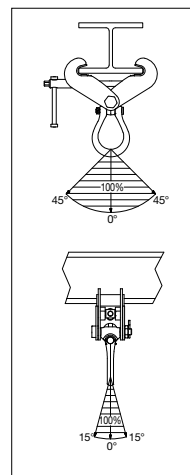

**IPTKU(D)**

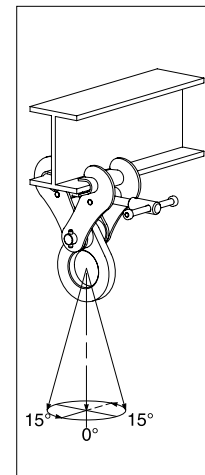

**IPTK(W)**