

IPHOZ

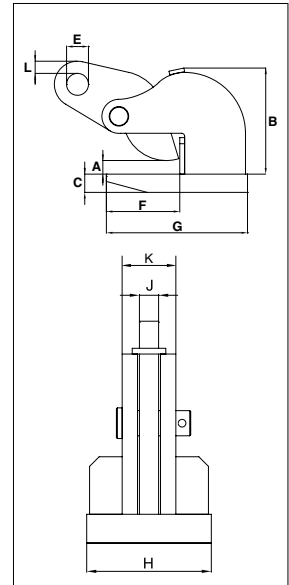

For Horizontal Lifting and Transfer

- Available in capacities of .75 through 15 metric tons (higher Working Load Limits are available upon request).
- Wide variety of jaw openings available: 0" to 2.38".
- Welded alloy steel body for strength and smaller size. Forged alloy, components where required.
- Equipped with handle for easy placement.
- Individually Proof Tested to 2 times the Working Load Limit with certification.
- Company name (Crosby IP), logo, Working Load Limit and jaw opening permanently stamped on body.
- Each product is individually serialized, with the serial number and Proof Load test date stamped on body. User manual with test certificate is included with each clamp.
- Maintenance and repair kits are available.



Model IPHOZ

Model	Working Load Limit (Per Pair) (t)*	Stock No.	Weight Each (lb)	Dimensions (in)									
				Jaw A	B	C	E	F	G	H	J	K	L
IPHOZ	0.75	2705401	6.0	0 - 1.19	3.70	0.63	0.63	2.76	4.65	3.19	0.47	1.22	0.47
IPHOZ	1.5	2705402	12.0	0 - 1.75	5.24	0.63	0.87	4.92	7.56	3.94	0.63	1.42	0.47
IPHOZ	3	2705403	17.0	0 - 1.75	5.39	0.79	1.02	4.92	7.87	4.72	0.79	1.89	0.39
IPHOZ	4.5	2705404	21.0	0 - 1.75	5.43	0.98	1.18	4.96	8.66	4.72	0.79	1.97	0.39
IPHOZ	6	2705405	34.0	0 - 2.38	6.73	1.18	1.42	5.31	9.25	5.12	0.79	2.20	0.79
IPHOZ	9	2705406	55.0	0 - 2.38	8.31	1.18	1.69	6.54	10.87	6.30	0.98	2.44	0.79
IPHOZ	12	2705407	64.0	0 - 2.38	8.54	1.57	1.85	6.61	11.57	7.48	0.98	2.44	0.75
IPHOZ	15	2705408	80.0	0 - 2.38	8.66	1.57	1.85	7.20	12.48	9.84	0.98	2.44	0.87

*Design Factor based on EN 13155 and ASME B30.20.

