

S-265

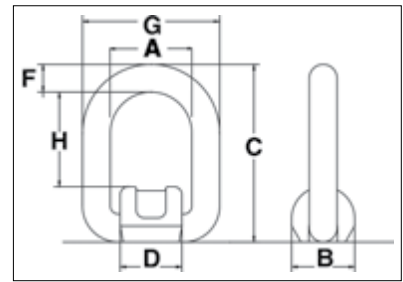

- Widely used on farm machinery, trucks, steel hulled marine vessels and material handling equipment.
- Forged link and bracket — Quenched & Tempered.
- Excellent welding qualities.
- Reference American Welding Society specifications for proper welding procedures.



APPLICATION AND WARNING INFORMATION
SECTION 17

S-265 Forged Link

Working Load Limit (lb)		Stock No.	Weight Each (lb)	Dimensions (in)						
Design Factor 5:1	Design Factor 4:1			A	B	C	D	F	G	H
2200	2600	1290839	0.90	1.70	1.58	3.11	1.42	0.51	2.72	1.50
5500	7050	1290848	1.80	1.93	1.89	3.78	1.62	0.71	3.35	1.73
9250	11650	1290857	3.30	2.21	2.40	5.04	1.89	0.87	3.94	2.48
14100	17600	1290866	6.00	2.88	2.88	5.95	2.56	1.02	4.92	2.88
26450	33050	1290875	13.0	3.94	3.54	7.64	3.55	1.34	6.62	3.74