

S-1325A

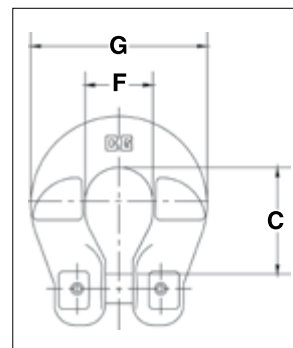

- Forged alloy steel — Quenched & Tempered.
- Designed to connect Grade 100 chain fittings produced with engineered flat to Grade 100 chain.
- Suitable for use with Grade 100 and Grade 80 chain.
- Individually Proof Tested to 2-1/2 times the Working Load Limit with certification.
- Locking system that provides for simple assembly and disassembly – no special tools required.
- Fatigue rated to 20,000 cycles at 1-1/2 times the Working Load Limit.



Crosby 8/10™ Fatigue Resistant QT

S-1325A Grade 100 Chain Coupler

Chain Size		Stock No.	Working Load Limit (lb)	Weight Each (lb)	Dimensions (in)		
(in)	(mm)				C	F	G
-	6	1098496	3200	.25	1.03	.74	1.74
1/4	7	1098500	4300	.50	1.41	.88	2.32
5/16	8	1098504	5700	.50	1.40	.88	2.32
3/8	10	1098508	8800	.80	1.84	1.18	2.72
1/2	13	1098512	15000	1.70	2.12	1.50	3.62
5/8	16	1098516	22600	1.90	2.84	1.96	4.40

4:1 Design Factor.

S-1311N



- Forged alloy steel - Quenched & Tempered.
- Individually Proof Tested to 2-1/2 times the Working Load Limit with certification.
- Suitable for use with Grade 100 and Grade 80 chain.
- Spring loaded chain locking system keeps chain in place under slack conditions.
- The use of S-1311N Chain Shortener will allow 100 percent of the chain sling capacity.
- Fatigue rated to 20,000 cycles at 1-1/2 times the Working Load Limit.

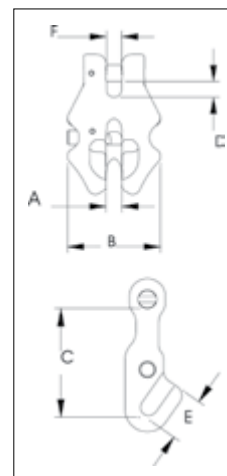

Crosby 8/10™ Fatigue Resistant QT

S-1311N Grade 100 Chain Shortener Link

Chain Size		Stock No.	Working Load Limit (lb)	Weight Each (lb)	Dimensions (in)					
(in)	(mm)				A	B	C	D	E	F
-	6	1017860	3200	.49	.30	1.76	1.83	.29	.76	.29
1/4	7	1017869	4300	.84	.34	2.04	2.17	.34	.88	.33
5/16	8	1017878	5700	1.22	.40	2.36	2.53	.39	1.01	.38
3/8	10	1017897	8800	2.03	.48	2.84	3.07	.48	1.23	.46
1/2	13	1017906	15000	4.31	.62	3.56	3.77	.61	1.57	.59
5/8	16	1017915	22600	7.20	.73	4.24	4.64	.73	1.91	.70

4:1 Design Factor.