

Crosby® Angular Contact Bearing Swivels

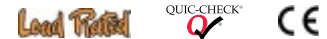

- Designed for high rotation speed, lower torque required to initiate rotation.
- Angular contact bearings maximize efficiency, reliability, and service life of swivel and extend the life of the wire rope.
- Entire swivel is zinc plated to resist corrosion.
- Individually Proof Tested to 2 times the Working Load Limit with certification.
- Hook models utilize genuine Crosby hooks which are forged alloy steel, quenched and tempered, and contain patented QUIC-CHECK® markings.
- Each swivel 8.5 short Tons and larger is furnished with a pressure lubrication fitting.
- For swivels larger than those listed, visit thecrosbygroup.com/engineeredolutions for more information.



AS-1 Jaw & Hook

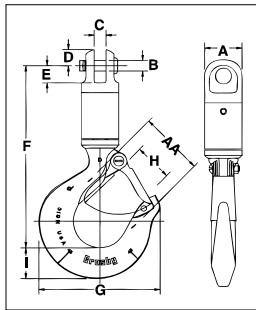

Working Load Limit (t)*	Wire Rope Size (in)	Stock No.	Weight Each (lb)	Dimensions (in)									Deformation Indicator AA	Replacement Latch Kit Stock No.
				A	B	C	D	E	F	G	H	I		
.40	1/8	1016001	.7	.88	.25	.25	.38	.41	4.32	2.86	.93	.73	1.50	1096325
.68	1/4	1016010	1.5	1.31	.38	.31	.44	.56	5.44	3.16	.97	.84	1.50	1096374
1.35	3/8	1016025	2.3	1.63	.50	.53	.69	.78	6.35	4.00	1.16	1.14	1.50	1096374
2.70	1/2	1016026	6.5	2.00	.75	.75	.94	1.19	8.69	4.84	1.41	1.44	2.50	1096374
4.50	5/8	1016040	12.9	2.50	.88	1.00	1.13	1.53	10.71	6.28	1.69	1.82	3.00	1096562
7.65	3/4	1016045	26.4	3.00	1.19	1.56	1.34	2.09	13.65	8.34	2.41	2.60	4.00	1096657
9.00	7/8	1016056	53.0	4.00	1.50	1.75	1.75	3.50	17.95	10.34	3.19	3.00	5.00	1096704
13.5	1	1016064	53.0	4.00	1.50	1.75	1.75	3.50	17.95	10.34	3.19	3.00	5.00	1096704
22.5	1-1/4	1016075	97.0	5.00	2.00	2.00	2.38	3.69	20.88	13.62	3.25	3.62	6.50	1090161
31.5	1-1/2	1016082	140.0	5.00	2.00	2.00	2.38	3.69	24.00	14.06	3.00	4.56	7.00	1090189

5:1 Design Factor. Individually Proof Tested to 2 times the Working Load Limit.

AS-2 Jaw & Jaw

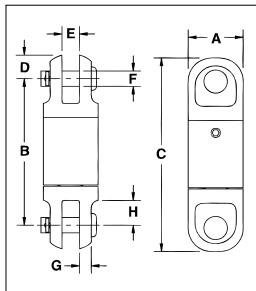

Working Load Limit (t)*	Wire Rope Size (in)	Stock No.	Weight Each (lb)	Dimensions (in)							
				A	B	C	D	E	F	G	H
.40	1/8	1016103	.4	.88	2.38	3.13	.38	.25	.25	.19	.41
.68	1/4	1016114	.9	1.31	3.56	4.44	.44	.31	.38	.22	.56
1.35	3/8	1016122	2.0	1.63	4.06	5.44	.69	.50	.50	.28	.78
2.70	1/2	1016131	4.9	2.00	6.25	8.13	.94	.75	.75	.38	1.19
4.50	5/8	1016139	9.6	2.50	7.75	10.63	1.13	1.00	.88	.53	1.53
7.65	3/4	1016148	15.8	3.00	9.63	12.31	1.34	1.56	1.19	.56	2.09
9.00	7/8	1016157	40.0	4.00	14.00	17.50	1.75	1.75	1.50	.81	3.50
13.5	1	1016166	40.0	4.00	14.00	17.50	1.75	1.75	1.50	.81	3.50
22.5	1-1/4	1016175	78.0	5.00	15.94	20.69	2.38	2.00	2.00	1.13	3.69
31.5	1-1/2	1016184	78.0	5.00	15.94	20.69	2.38	2.00	2.00	1.13	3.69

5:1 Design Factor. Individually Proof Tested to 2 times the Working Load Limit.