

O-318

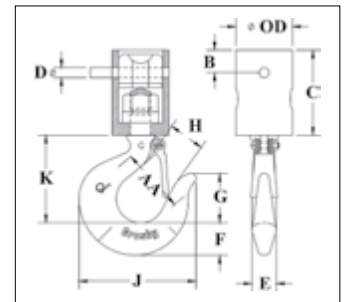

- With ball bearing swivel; attaches to chain by an alloy pin.
- Suitable for frequent rotation under load.
- HO-318 Hooks utilize Crosby SHUR-LOC® positive locking hooks. Latch is self-locking when hook is loaded.
- O-319 Hooks utilize Crosby® standard 319 Shank Hooks which incorporate QUIC-CHECK® deformation and angle indicators. (For detailed information, see the Crosby Value Added page at the beginning of this section.)
- Entire assembly is zinc plated.
- Repair kit available consisting of bearing and spring pin.

O-319

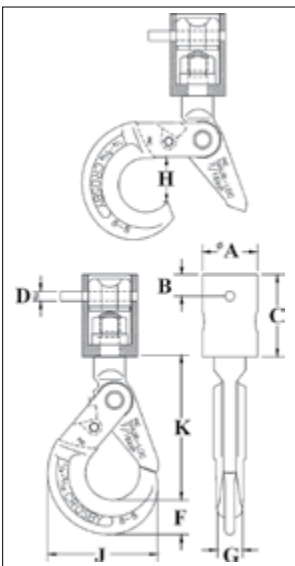

APPLICATION AND WARNING INFORMATION
SECTION 17

O-318 Chain Nest Hooks

Chain Size (in)	Stock No.	WLL (short Tons)*	Weight Each (lb)	Dimensions (in)										Replacement Trigger Kit Stock No.
				A	B	C	D	F	G	H	J	K		
1/4 - 9/32	1098409	1.5	1.7	1.75	.70	2.62	.31	1.10	.81	1.46	3.50	4.59	6603011	
5/16 - 3/8	1098427	2.1	2.3	2.13	.70	3.19	.38	1.15	.94	1.83	4.35	5.65	6603012	
3/8 - 7/16	1098445	3.8	4.2	3.00	1.00	4.38	.50	1.66	1.16	2.11	5.45	7.06	6603013	
1/2 - 9/16	1098463	3.8	4.2	3.00	1.00	4.38	.63	1.66	1.16	2.11	5.45	7.06	6603013	

4:1 Design Factor.

O-319 Chain Nest Hooks

Chain Size (in)	Stock No.	WLL (short Tons)*	Weight Each (lb)	Dimensions (in)											Replacement Trigger Kit Stock No.
				OD	AA	B	C	D	E	F	G	H	J	K	
1/4 - 9/32	1098312	1.5	1.7	1.75	2.00	.70	2.62	.31	.75	1.00	1.53	1.00	3.62	2.69	1096421
5/16 - 3/8	1098334	2.1	2.3	2.13	2.00	.70	3.19	.38	.84	1.12	1.72	1.12	4.09	3.06	1096468
3/8 - 7/16	1098356	3.8	4.2	3.00	2.50	1.00	4.38	.50	1.12	1.44	2.12	1.34	4.84	3.78	1096515
1/2 - 9/16	1098378	3.8	4.2	3.00	2.50	1.00	4.38	.63	1.12	1.44	2.12	1.34	4.84	3.78	1096515

4:1 Design Factor. *Deformation indicators.