

Crosby® Release & Retrieve ROV Shackle

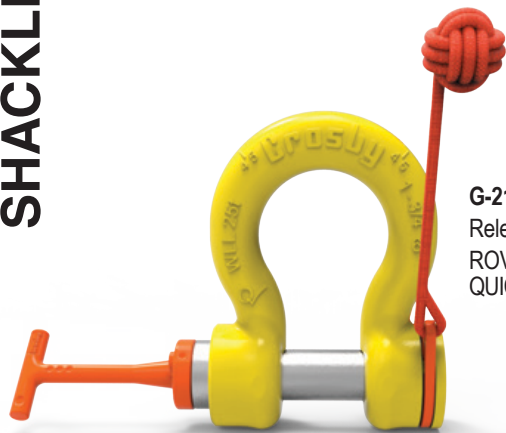

G-2100
Release & Retrieve
ROV Shackle with
QUIC-Thread Bolt



G-2110
Release & Retrieve
ROV Shackle with
Non - Thread Bolt

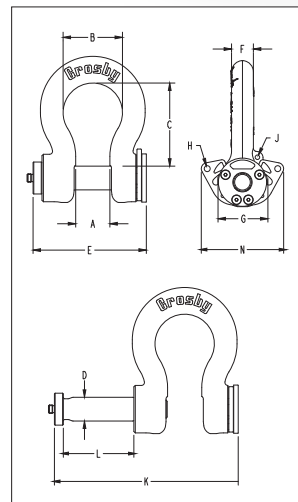
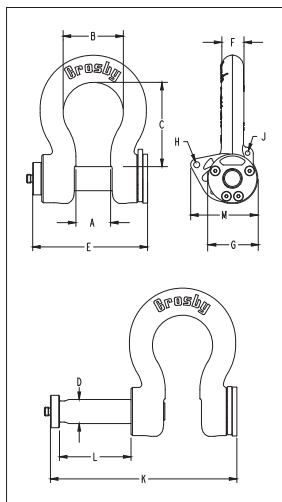

- Forged alloy bow with an industry best 6 to 1 performance design factor.
- Patent pending captured bolt can withstand over 2,000 lbs. (907 kg) of pull-out force.
- Galvanized bow with an API RP 17H color compliant coating.
- Galvanized alloy bolt (Non-Threaded) (**G-2110**)
- On average, QUIC-Thread bolt requires only 3.5 rotations for full engagement (**G-2100**)
- Raised pad for serialization.
- API RP 17H compliant 316 stainless steel handles available in T, D, F, and Eye models (sold separately)
- Built in eyelets for optional tether points.
- Monkey fist(s) included
- Capacities from 9-1/2t through 85t.
- Forged Steel, Quenched & Tempered, with alloy pins.
- Working Load Limit permanently shown on every shackle.
- **QUIC-CHECK®** deformation and angle indicators forged on the bow.

Load Rated®



SEE APPLICATION INFORMATION
On Page 92 of the General Catalog
Para Español: www.thecrosbygroup.com

G-2100 ROV Release & Retrieve Shackle — QUIC-Threaded

| Working Load Limit (t)* | Stock No. | Weight Each (lb) | Dimensions (in) | | | | | | | | | | | |
|-------------------------|-----------|------------------|-----------------|------|-------|------|-------|------|------|------|------|-------|------|------|
| | | | A | B | C | D | E | F | G | H | J | K | L | N |
| 9.5 | 2038739 | 11.4 | 1.81 | 2.91 | 4.25 | 1.25 | 7.33 | 1.16 | 2.68 | 0.38 | 0.31 | 11.54 | 4.21 | 4.97 |
| 12 | 2038762 | 13.8 | 2.03 | 3.25 | 4.69 | 1.38 | 7.75 | 1.29 | 3.00 | 0.38 | 0.31 | 12.25 | 4.50 | 4.97 |
| 17 | 2038785 | 23.7 | 2.38 | 3.88 | 5.75 | 1.63 | 8.54 | 1.53 | 3.62 | 0.50 | 0.31 | 13.74 | 5.20 | 6.28 |
| 25 | 2038614 | 38.6 | 2.88 | 5.00 | 7.00 | 2.00 | 9.54 | 1.84 | 4.20 | 0.50 | 0.38 | 15.48 | 5.94 | 6.94 |
| 35 | 2038808 | 51.2 | 3.25 | 5.75 | 7.74 | 2.28 | 10.41 | 2.08 | 4.82 | 0.50 | 0.38 | 16.97 | 6.56 | 6.94 |
| 55 | 2038831 | 108 | 4.12 | 7.25 | 10.49 | 2.78 | 12.61 | 2.72 | 5.81 | 0.50 | 0.38 | 20.74 | 8.13 | 8.53 |
| 85 | 2038877 | 157 | 5.00 | 7.88 | 12.98 | 3.28 | 14.23 | 3.12 | 6.50 | 0.50 | 0.50 | 23.61 | 9.38 | 8.53 |

*Minimum Ultimate Load is 6 times the Working Load Limit in metric tons. *Note: Maximum Proof Loads are 2xWLL in metric tons.

G-2110 ROV Release & Retrieve Shackle — Non-Threaded

| Working Load Limit (t)* | Stock No. | Weight Each (lb) | Dimensions (in) | | | | | | | | | | | |
|-------------------------|-----------|------------------|-----------------|------|-------|------|-------|------|------|------|------|-------|------|------|
| | | | A | B | C | D | E | F | G | H | J | K | L | N |
| 9.5 | 2038740 | 11.4 | 1.81 | 2.91 | 4.25 | 1.25 | 7.33 | 1.16 | 2.68 | 0.38 | 0.31 | 11.54 | 4.21 | 4.97 |
| 12 | 2038763 | 13.8 | 2.03 | 3.25 | 4.69 | 1.38 | 7.75 | 1.29 | 3.00 | 0.38 | 0.31 | 12.25 | 4.50 | 4.97 |
| 17 | 2038786 | 23.7 | 2.38 | 3.88 | 5.75 | 1.63 | 8.54 | 1.53 | 3.62 | 0.50 | 0.31 | 13.74 | 5.20 | 6.28 |
| 25 | 2038621 | 38.6 | 2.88 | 5.00 | 7.00 | 2.00 | 9.54 | 1.84 | 4.20 | 0.50 | 0.38 | 15.48 | 5.94 | 6.94 |
| 35 | 2038809 | 51.2 | 3.25 | 5.75 | 7.74 | 2.28 | 10.41 | 2.08 | 4.82 | 0.50 | 0.38 | 16.97 | 6.56 | 6.94 |
| 55 | 2038832 | 108 | 4.12 | 7.25 | 10.49 | 2.78 | 12.61 | 2.72 | 5.81 | 0.50 | 0.38 | 20.74 | 8.13 | 8.53 |
| 85 | 2038878 | 157 | 5.00 | 7.88 | 12.98 | 3.28 | 14.23 | 3.12 | 6.50 | 0.50 | 0.50 | 23.61 | 9.38 | 8.53 |

*Minimum Ultimate Load is 6 times the Working Load Limit in metric tons. *Note: Maximum Proof Loads are 2xWLL in metric tons.