



**S-377**  
BARREL HOOKS

- Forged Carbon Steel - Quenched and Tempered.
- Meets the performance requirements of Federal Specification RR-C-271G, Type V, Class 6, except for those provisions required of the contractor.



**S-377 Barrel Hooks**

Working Load Limit Per Pair (Tons)*	S-377 Stock No. Per Pair	Weight Each Per Pair (lb)	Dimensions (in)			
			I.D. of Eye	O.D. of Eye	Overall Length	Width of Lip
1	1028248	3.56	1.56	2.81	5.00	2.88

\*Ultimate Load is 4 times the Working Load Limit.



**S-3316**  
REPLACEMENT HOOK

- Easily attaches to any chain and electric hoist with welded link load chain, roller chain or wire rope with suitable end fitting
- Swivel jaw is forged.
- Suitable for infrequent, non-continuous rotation under load.
- Use in corrosive environment requires shank and nut inspection in accordance with ASME B30.10-1.10.4(b)(5)(c).

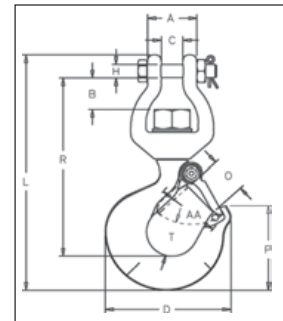

Load Rated®



**SEE APPLICATION AND WARNING INFORMATION**  
 On Pages 142 - 143  
 Para Español: [www.thecrosbygroup.com](http://www.thecrosbygroup.com)

**S-3316 Replacement Hook**

Working Load Limit (Tons)*	Frame Code	S-3316 Stock No.	Weight Each (lb)	Dimensions (in)										Replacement Latch Kit Stock No.
				A	B	C	D	H	L	O	P	R	T	
1/2	F	1023029	1.25	1.31	.76	.56	3.19	.38	6.12	.97	2.25	4.59	.81	1096374
1	H	1023047	2.61	1.56	1.00	.69	4.09	.44	7.69	1.12	2.84	5.81	1.19	1096468

\*Ultimate Load is 5 times the Working Load Limit.



**A-378**  
SORTING HOOK

- Forged Alloy Steel - Quenched and Tempered.
- Deep straight throat permits efficient handling of flat plates or large cylindrical shapes.



**A-378**  
SORTING HOOK

**A-378 Sorting Hook**

Working Load Limit at tip of Hook (Tons)*	Working Load Limit at bottom of Hook (Tons)*	A-378 Stock No	Style	Weight Each (lb)	Dimensions (in)			
					I.D. of Eye	Overall Length	Opening at top of Hook	Radius at bottom of Hook
2	7-1/2	1028024	No Handle	6.42	1.38	9.69	2.81	.625
2	7-1/2	1028033	With Handle	6.42	1.38	9.69	2.81	.625

\*Ultimate Load is 4 times the Working Load Limit.