

the **Crosby** group,
inc.

ROV

PRODUCTS

L320R



G209R



L562A



For efficient load handling and attachment by Remote Operating Vehicles in subsea and other hard-to-reach applications.

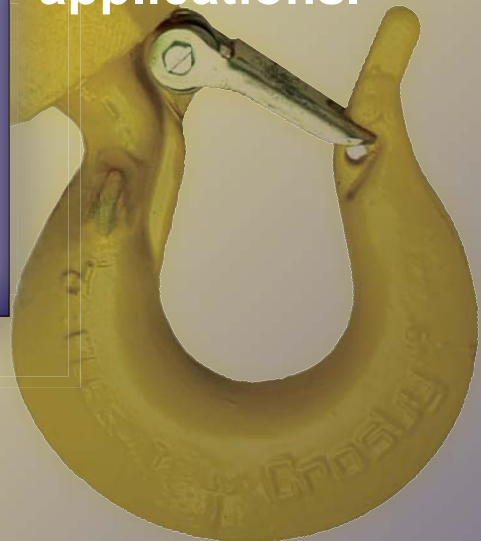

Developed in conjunction with major North Sea subsea operations.

Crosby Products Distributed By:

Crosby® ROV Eye Hooks

Load Rated



Crosby® ROV Hooks incorporate the following:

- Hook identification code stamped on each hook.
- Quenched and Tempered
- QUIC-CHECK® deformation and angle indicators forged on the hook.
- Fluorescent yellow finish for high “subsea” visibility.
- Tip extension allows for easy handling.
- Sizes 3.2t through 31.5t utilize new integrated latch (S-4320) that meets the World class standard for lifting.
- Heavy duty stamped latch interlocks with the hook tip.
- High cycle, long life spring.



**L320R
Eye Hooks**

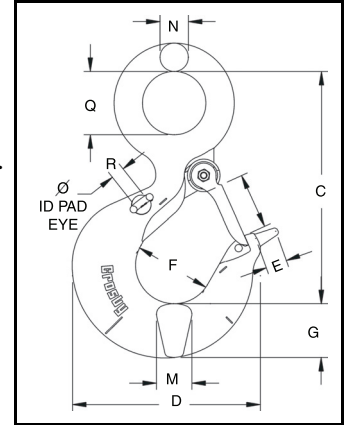

L320R Eye Hooks - Metric

L320R Stock No.	Working Load Limit (t) *	Hook ID Code	Weight Each (kg)	Dimensions (mm)										Replacement Latch Stock No.
				C	D	E	F	G	M	N	O	Q	R	
1298427†	3.2	HA	1.01	119	101	25	41	29	24	15	28	32	6	1096468
1298497†	5.4	IA	2.04	147	122	25	51	37	33	18	35	40	6	1096515
1298567†	8	JA	3.92	187	159	35	64	46	42	23	41	51	10	1096562
1298637†	11.5	KA	7.02	230	189	35	76	57	41	28	53	62	10	1096609
1298707†	16	LA	10.1	256	211	35	83	66	49	32	58	72	10	1096657
1298777†	22	NA	18.4	318	262	45	108	76	60	40	77	89	19	1096704
1298847	31.5	OA	28.1	357	346	—	127	92	76	44	93	89	19	1090161
1298857	37	PA	48.5	462	357	—	137	116	81	51	95	114	19	1090189
1298867	45	SA	62.1	511	392	—	152	129	82	55	114	125	19	1090189
1298877	60	TA	102	602	470	—	178	152	99	64	130	145	19	1090205

* Minimum Ultimate Load is 4 times the Working Load Limit.

† Utilizes Crosby S320N style hook.

Pad eyes are provided on either side of hook as cable guides. The cable is passed through a hole drilled in the latch that assists in allowing the “remotely operated” cable to open latch.



Cables and drilled latches are not provided by Crosby. They can be fitted by your local Authorized Crosby Dealer. Crosby allows you to modify the latch as required to accomplish the task.

L320R Eye Hooks - Inches

L320R Stock No.	Working Load Limit (t) *	Hook ID Code	Weight Each (lbs.)	Dimensions (in.)										Replacement Latch Stock No.
				C	D	E	F	G	M	N	O	Q	R	
1298427†	3.2	HA	2.0	4.69	3.97	.39	1.63	1.13	.94	.58	1.09	1.25	.25	1096468
1298497†	5.4	IA	4.0	5.77	4.81	.39	2.00	1.44	1.31	.72	1.36	1.56	.25	1096515
1298567†	8	JA	8.2	7.37	6.27	.79	2.50	1.81	1.66	.90	1.61	2.00	.38	1096562
1298637†	11.5	KA	15	9.07	7.45	1.18	3.00	2.25	1.63	1.11	2.08	2.44	.38	1096609
1298707†	16	LA	21	10.08	8.30	1.18	3.25	2.59	1.94	1.27	2.27	2.84	.38	1096657
1298777†	22	NA	38	12.53	10.30	1.77	4.25	3.00	2.38	1.56	3.02	3.50	.75	1096704
1298847	31.5	OA	60	14.07	13.63	—	5.00	3.62	3.00	1.75	3.67	3.50	.75	1090161
1298857	37	PA	107	18.19	14.06	—	5.38	4.56	3.19	2.00	3.75	4.50	.75	1090189
1298867	45	SA	137	20.12	15.45	—	6.00	5.06	3.24	2.18	4.25	4.94	.75	1090189
1298877	60	TA	224	23.72	18.50	—	7.00	6.00	3.91	2.53	5.12	5.69	.75	1090205

* Minimum Ultimate Load is 4 times the Working Load Limit.

† Utilizes Crosby S320N style hook.

Additional Working Load Limits for L320R and L562A available upon request.

Crosby® ROV Shank Hooks

Load Rated



L562A
Style Shown
5.4t - 31.5t

Crosby® ROV Shank Hooks incorporate the following:

- Hook identification code stamped on each hook.
- Quenched and Tempered
- QUIC-CHECK® angle indicators forged into the top eye; and deformation and angle indicators forged on the hook.
- Fluorescent yellow finish for high “subsea” visibility.
- Tip extension allows for easy handling.
- Sizes 5.4t through 31.5t utilize new integrated latch (S-4320) that meets the World class standard for lifting.
 - Heavy duty stamped latch interlocks with the hook tip.
 - High cycle, long life spring.

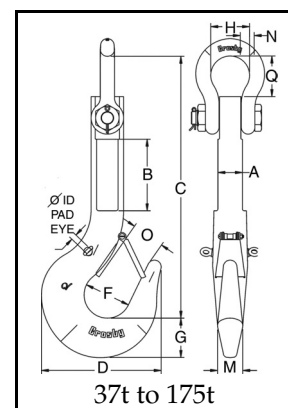
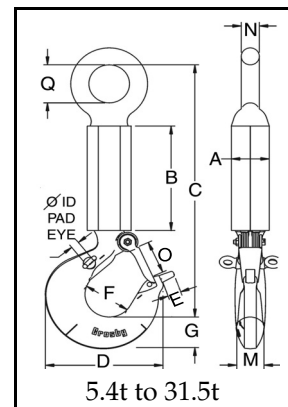

L562A Shank Hooks - Metric

L562A Stock No.	Working Load Limit (t) *	Hook ID Code	Weight Each (kg)	Dimensions (mm)													Replacement Latch Stock No.
				A	B	C	D	E	F	G	H	M	N	Q	O	R	
1297722†	5.4	IA	9.5	65	250	421	123	9.9	51	37	—	29	22	51	35	6.4	1096515
1297792†	11.5	KA	15	65	250	518	192	30	76	57	—	41	32	76	53	9.7	1096609
1297806†	16	LA	18	65	250	550	212	30	83	66	—	49	35	79	58	9.7	1096657
1297862†	22	NA	31	85	250	608	263	45	108	76	—	60	40	91	77	19	1096704
1298042	31.5	OA	44	85	250	660	346	—	127	92	104	76	48	106	92	19	1090161
1298049**	37	PA	44	80	235	828	357	—	137	116	127	76	47	134	95	19	1090189
1298057**	45	SA	90	80	235	865	392	—	152	129	127	83	47	134	108	19	1090189
1298087**	60	TA	131	90	215	941	470	—	178	152	146	99	53	150	130	19	1090205
1298103**	100	WA	303	140	300	1185	584	—	173	218	184	140	69	190	124	19	1090241
1298117**	150	XA	395	150	230	1233	619	—	171	232	229	152	92	309	137	19	1090241
1298130**	175	YA	515	170	255	1326	678	—	191	248	254	178	102	300	—	19	—

* Minimum Ultimate Load is 4 times the Working Load Limit. ** Utilize Crosby G-2140 shackle as eye. † Utilizes Crosby S319N style hooks.

L562A Shank Hooks - Inches

L562A Stock No.	Working Load Limit (t) *	Hook ID Code	Weight Each (lbs.)	Dimensions (in.)													Replacement Latch Stock No.
				A	B	C	D	E	F	G	H	M	N	Q	O	R	
1297722†	5.4	IA	21	2.56	9.84	16.60	4.84	.39	2.00	1.44	—	1.13	.88	2.00	1.36	.25	1096515
1297792†	11.5	KA	33	2.56	9.84	20.39	7.54	1.18	3.00	2.26	—	1.63	1.25	3.00	2.08	.38	1096609
1297806†	16	LA	42	2.56	9.84	21.65	8.34	1.18	3.25	2.60	—	1.94	1.38	3.11	2.27	.38	1096657
1297862†	22	NA	68	3.35	9.84	23.75	10.34	1.77	4.25	3.01	—	2.38	1.59	3.58	3.02	.75	1096704
1298042	31.5	OA	97	3.35	9.84	26.00	13.62	—	5.00	3.62	4.10	3.00	1.89	4.21	3.62	.75	1090161
1298049**	37	PA	97	3.15	9.25	32.58	14.06	—	5.38	4.56	5.00	3.00	1.84	5.26	3.75	.75	1090189
1298057**	45	SA	198	3.15	9.25	34.07	15.44	—	6.00	5.06	5.00	3.25	1.84	5.26	4.25	.75	1090189
1298087**	60	TA	289	3.54	8.46	37.06	18.50	—	7.00	6.00	5.75	3.91	2.08	5.94	5.12	.75	1090205
1298103**	100	WA	668	5.51	11.81	46.67	23.00	—	6.81	8.59	7.25	5.50	2.71	7.47	4.88	.75	1090241
1298117**	150	XA	871	5.91	9.06	48.53	24.38	—	6.75	9.12	9.00	6.00	3.62	12.18	5.38	.75	1090241
1298130**	175	YA	1135	6.69	10.04	52.24	26.69	—	7.50	9.75	10.00	7.00	4.00	11.80	—	.75	—

* Minimum Ultimate Load is 4 times the Working Load Limit. ** Utilize Crosby G-2140 shackle as eye. † Utilizes Crosby S319N style hooks.

Crosby® ROV Shackles

Fatigue Rated® Load Rated®



**G209R
ROV Shackle**

G209R ROV Shackles offer:

- Capacities 6-1/2 through 55 metric tonnes.
- Forged - Quenched and Tempered, with alloy pins.
- QUIC-CHECK® deformation and angle indicators forged on the bow.
- All ROV shackle bows, unless otherwise noted below, are galvanized, then painted fluorescent yellow.

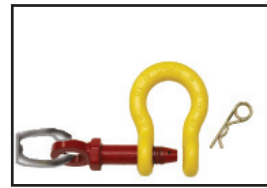
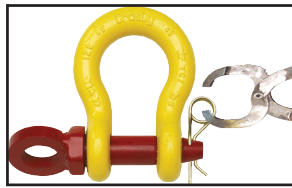
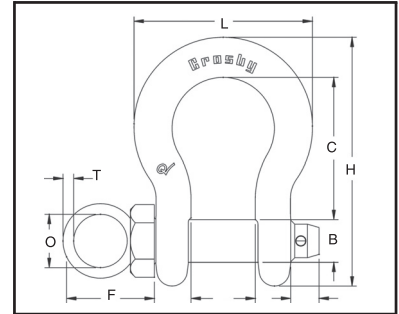

G209R ROV Shackle - Metric

G209R Stock No.	Working Load Limit (t) *	Weight Each (kg)	Dimensions - Body (mm)					Dimensions - Pin (mm)			
			A	B	C	H	L	O	P	T	S
1020872	6-1/2	1.79	36.6	25.4	84	148	102	50	58	10	17
1020902	8-1/2	2.28	42.9	28.7	95.5	167	119	50	61	10	18
1020932	9-1/2	3.75	46	31.8	108	190	131	70	83	12	18
1020952	12	5.31	51.5	35.1	119	210	146	70	84	12	23
1020972	13-1/2	7.18	57	38.1	133	233	162	75	91	15	23
1020992	17	9.43	60.5	41.4	146	254	175	75	93	15	24
1021102	25†	15.4	73	51	178	313	225	90	114	17.5	29
1021125	35†	23.7	82.5	57	197	348	253	106	132	20	30
1021158	55†	44.6	105	70	267	453	327	120	145	25	45

* Minimum Ultimate Load is 5 times the Working Load Limit. † Furnished with galvanized finish

G209R ROV Shackle - Inches

G209R Stock No.	Working Load Limit (t) *	Weight Each (lbs.)	Dimensions - Body (in.)					Dimensions - Pin (in.)			
			A	B	C	H	L	O	P	T	S
1020872	6-1/2	3.62	1.44	1.00	3.31	5.83	.50	1.18	2.28	.39	.65
1020902	8-1/2	5.03	1.69	1.13	3.75	6.56	.56	1.18	2.40	.39	.73
1020932	9-1/2	7.41	1.81	1.25	4.25	7.47	.63	2.28	3.27	.47	.75
1020952	12	9.50	2.03	1.38	4.69	8.25	.69	2.28	3.31	.47	.89
1020972	13-1/2	13.53	2.25	1.50	5.25	9.16	.75	2.36	3.58	.59	.91
1020992	17	17.20	2.38	1.63	5.75	10.00	.81	2.36	3.66	.59	1.18
1021102	25†	27.78	2.88	2.00	7.00	12.34	1.00	2.16	4.49	.69	1.14
1021125	35†	45.00	3.25	2.25	7.75	13.68	1.22	2.60	5.12	.79	1.18
1021158	55†	85.75	4.13	2.75	10.50	17.84	1.38	2.76	5.63	.98	1.50

* Minimum Ultimate Load is 5 times the Working Load Limit. † Furnished with galvanized finish

theCrosbygroup, inc.

USA

P.O. Box 3128
Tulsa, OK 74101
(918) 834-4611
Fax: (918) 832-0940
crosbygroup@thecrosbygroup.com

CANADA

145 Heart Lake Road
Brampton, Ontario L6W 3K3
(905) 451-9261
Fax: (877) 260-5106
sales@crosby.ca

EUROPE

Industriepark Zone B nr 26
B - 2220 Heist-op-den-Berg Belgium
32-15-75-71-25
Fax: 32-15-75-37-64
sales@crosbyeurope.com