

New from Crosby® ...

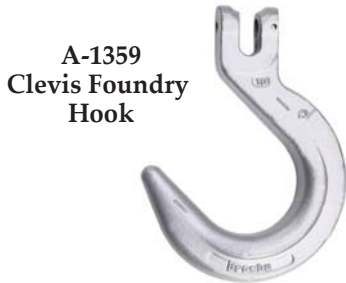

A-1358
Grab Hook



A-1359
Clevis Foundry
Hook



Crosby 8/10™

Grade 100 Chain Hooks

- ✓ Forged alloy steel - Quenched and Tempered.
- ✓ Individually Proof Tested to 2-1/2 times the Working Load Limit with certification.
- ✓ Each hook has a Product Identification Code (PIC) for material traceability, along with the size and the name Crosby & USA in raised letters.
- ✓ Suitable for use with Grade 100 and Grade 80 chain in overhead lifting applications as long as hook is Proof Tested as part of the chain sling assembly or as an individual component. (Per ANSI B30.9-1.)
- ✓ Fatigue rated at 1-1/2 times the Working Load Limit at 20,000 cycles.
- ✓ "Look for the Platinum Color - Crosby Grade 100 Alloy Products."

The use of A-1358 Clevis Grab Hook will result in a 20% reduction in chain capacity. When used to hook back to chain leg to form a choker, the angle of the choke must be 120 degrees or greater. When used as a chain shortener, minimize twist of chain and ensure chain is fully engaged in hook.

Chain Size		A-1358 Stock No.	Working Load Limit (lbs.)*	Weight Each (lbs.)	Dimensions (in.)				
(in.)	(mm)				A	B	C	D	F
1/4	7	1049610	4,300	1.00	1.72	2.54	2.20	3.88	0.88
5/16	8	1049629	5,700	1.00	1.72	2.54	2.18	3.88	0.88
3/8	10	1049638	8,800	1.70	1.85	3.09	2.58	4.69	1.09
1/2	13	1049647	15,000	3.40	2.39	3.83	3.28	5.88	1.42
5/8	16	1049656	22,600	6.10	2.67	4.52	3.85	7.03	1.75

* Ultimate Load is 4 times the Working Load Limit.

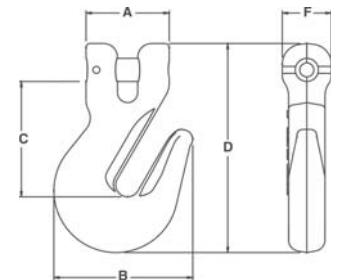

A-1358 Grab Hook

A-1359 Foundry hooks incorporate strategically placed markings into the product which address the Crosby QUIC-CHECK® feature of deformation indicators.



Chain Size		A-1359 Stock No.	Working Load Limit (lbs.)*	Weight Each (lbs.)	Dimensions (in.)					
(in.)	(mm)				A	C	D	F	G	N
1/4	7	1049907	4,300	2.00	6.26	4.39	4.81	2.50	1.13	1.56
5/16	8	1049911	5,700	2.10	6.26	4.37	4.81	2.50	1.13	1.56
3/8	10	1049916	8,800	4.30	7.76	5.54	5.81	3.00	1.38	1.88
1/2	13	1049925	15,000	7.50	9.38	6.67	6.88	3.50	1.63	2.25
5/8	16	1049934	22,600	13.40	11.25	7.68	8.17	4.00	2.19	2.53

* Ultimate Load is 4 times the Working Load Limit.

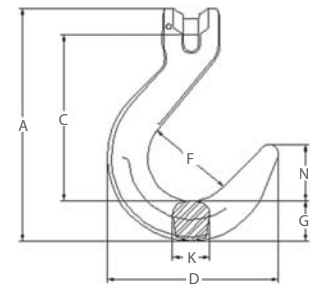

A-1359 Clevis Foundry Hook

theCrosby® group
www.thecrosbygroup.com

Crosby U.S.A.
P. O. Box 3128
Tulsa, Oklahoma 74101
U.S.A.
(918) 834-4611
Fax: (918) 832-0940
crosbygroup@thecrosbygroup.com

Crosby Canada
145 Heart Lake Road
Brampton, Ontario
L6W 3K3 Canada
(905) 451-9261
Fax: (877) 260-5106
sales@crosby.ca

Crosby Europe nv
Leuvensebaan 51
2580 Putte
(Mechelen) Belgium
+32-15-75 71 25
Fax: +32-15-75 37 64
sales@crosbyeurope.com

CROSBY PRODUCTS DISTRIBUTED BY:

www.thecrosbygroup.com