

VERTICAL TRANSPORT OF PLATES: VERY THIN, LARGE PLATES

IPTPU(X)

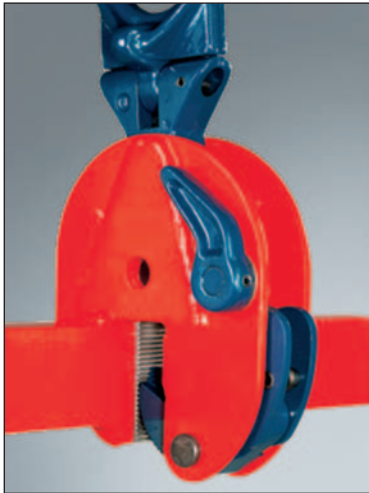

Model IPTPUX

IPTPU lifting clamp are used to lift up very thin, large steel plates from the horizontal to the vertical position and to turn them. The specific design of this model prevents the plates from **'buckling'** while being lifted.

Depending on the size of the plate as well as other factors, you may either decide on the standard **IPTPU** version or select the special **IPTPUX** model, which is equipped with **lateral supporting profiles**.

For correct use of the clamp, please consult fig. 2 and 3.

The minimum working load must be at least 10% of the rated WLL.



Model IPTPU

Before using the clamp always read the instruction manual supplied with the clamp.

Model	Order No.	WLL per pce in t.	Jaw		Dimensions in mm								Weight per pce kg
			A	B	C	D	E	F	G	H	J	K	
1,5-IPTPU	3138	1,5	0-15	80	200	376	70	180	61	64	-	16	7,5
3 -IPTPU	3147	3,0	0-15	85	241	424	75	211	78	61	-	20	16,0
With supporting profiles													
1,5-IPTPUX	3145	1,5	0-15	80	200	376	70	180	461	64	-	16	9,5
3 -IPTPUX	3146	3,0	0-15	85	241	424	75	211	478	61	-	20	18,0

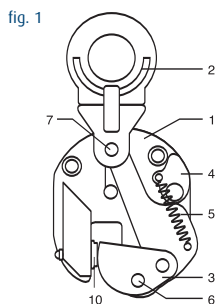
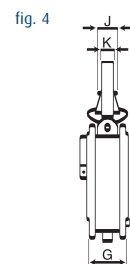
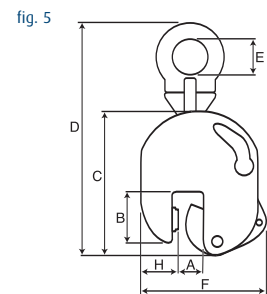

Spare parts for IPTPU lifting clamps:

	Order no.
1. body complete	1041
2. hoisting eye complete	1235
3. camsegment complete	1234
4. latch complete	1233
5. spring for latch complete	1063
6. camsegment shaft complete	1046
7. hoisting eye shaft complete	1047
10. pivot complete (round)	0098
10. pivot complete (oval)	0099

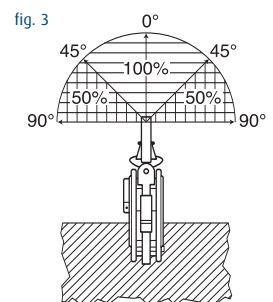
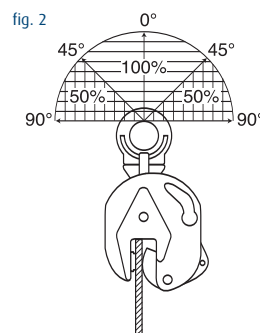

innovative

Inter Product, the market leader in lifting clamps