

Shipbuilding Clamps: Bulb Profiles

IPBUZ

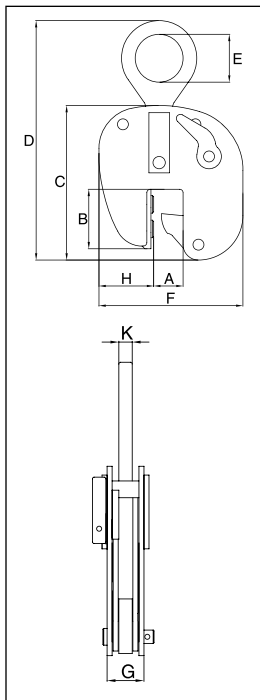

The IPBUZ shipbuilding clamps are used for the lifting, transfer and placing of bulb profiles onto ship's hulls perpendicularly. These clamps are fitted with a locking device for both open and closed positions, which ensures complete reliability. They are to be used exclusively for bulb profiles (not for plates).



For the lifting, transfer and placing of Bulb Profiles onto Ship's Hulls Perpendicularly

- Available in capacities of .75 thru 3.75 metric tons.
- Jaw openings available: HP 4.75" to HP 17.00".
- Welded alloy steel body for strength and smaller size. Forged alloy components, where required.
- Individually Proof Tested to 2 times the Working Load Limit with certification.
- Company name (CrosbyIP), logo, Working Load Limit and jaw opening permanently stamped on body.
- Each product is individually serialized, with the serial number and Proof Load test date stamped on body. Serial number is included on the test certificate with maintenance and warranty logbook.
- Optional IP-5000 Stinger assembly available (see page 420). Allows for easy connection between the clamp and hoist hook.
- Maintenance replacement parts are available.
- Manufactured by a ISO 9001 facility.
- All sizes are **RFID EQUIPPED**.



Load Rated

Model IPBUUZ: with Universal Hoisting Eye Model IPBUUZ: with Fixed Hoisting Eye

Model	Working Load Limit (t)*	Stock No.	Weight Each (lbs.)	Dimensions (in.)								
				Jaw A	B	C	D	E	F	G	H	K
IPBUUZ	.75	2705601	18.7	HP 4.75-7.88	3.35	8.90	15.35	2.76	8.27	2.40	2.76	.63
With fixed hoisting eye												
IPBUZ	.75	2705600	15.4	HP 4.75-7.88	3.35	8.90	15.35	2.76	8.27	2.40	2.76	.63
IPBUZ	1.5	2705701	33.1	HP 8.63-17.00	7.72	15.63	22.36	2.76	10.08	2.72	1.89	.63
IPBUZ	3.75	2705702	62.9	HP 8.63-17.00	9.37	17.24	22.24	3.15	13.98	2.52	3.94	.79

* Design Factor based on EN 13155 and ASME B30.20.

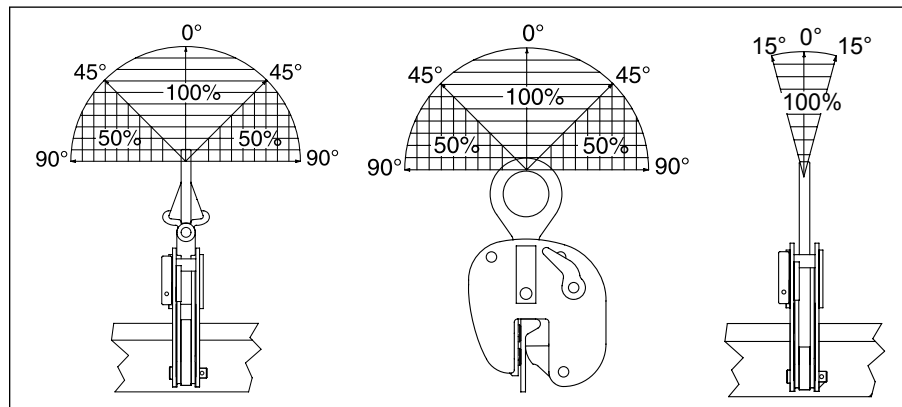

Crosby Lifting Clamps