

Shank Hooks for Swaging



**SEE APPLICATION AND
WARNING INFORMATION**

Para Español: www.thecrosbygroup.com

On Pages 61-62

S-319SWG



- Wide range of sizes available:
 - Working Load Limit: 0.4-14 Ton
 - Wire Rope sizes: 3/16" through 1-1/8".
- Swage shank hook terminations have an efficiency rating of 95% based on the catalog strength of wire rope.
- Quenched and Tempered. Heat treat process allows for ease of swaging.
- Forged Carbon Steel.
- Design Factor of 5 to 1.
- Black Oxide finish on body (Shank is uncoated).
- Utilizes standard Crosby 319N shank hooks with interlocking hook tip. Each hook has a pre-drilled cam which can be equipped with a latch.
- Utilizes standard National Swage swaging dies.
- All hooks incorporate Crosby's patented **QUIC-CHECK®** markings (Angle Indicators and Throat Deformation Indicators). See page 110 for detailed information.

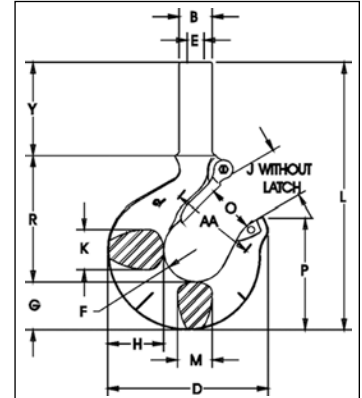

NOTE: For use with 6 X 19 or 6 X 37, IPS or XIP (EIP), XXIP (EEIP), RRL, FC, or IWRC wire rope.

Before using any Crosby fitting with any other type lay, construction or grade of wire rope, it is recommended that the termination be destructive tested and documented to prove the adequacy of the assembly to be manufactured. Refer to swage socket or swage button instructions in the National Swage Swaging Products and Procedures Brochure for proper swaging techniques.

S-319SWG Shank Hooks for Swaging

Wire Rope Size		Hook ID Code	Working Load Limit (Tons)*	S-319SWG Stock No.	Weight Each (lbs.)	Required Swaging Die		Maximum After Swage Diameter (in.)
(in.)	(mm)					Die Description	Die Stock No.	
3/16	5	DC	0.4	1053002	.55	1/8" Button	1191621	.40
1/4	6-7	FC	0.7	1053011	.77	1/4" Socket	1192845	.46
5/16	8	GC	1.1	1053020	1.26	1/4" Button	1191621	.58
5/16	8	HC	1.1	1053039	1.83	3/8" Socket	1192863	.71
3/8	9-10	HC	1.6	1053048	1.80	3/8" Socket	1192863	.71
7/16	11	IC	2.1	1053057	3.63	1/2" Socket	1192881	.91
1/2	12-13	IC	2.8	1053066	3.58	1/2" Socket	1192881	.91
9/16	14-15	JC	3.5	1053075	7.37	5/8" Socket	1192907	1.16
5/8	16	JC	4.3	1053084	7.30	5/8" Socket	1192907	1.16
3/4	18	KC	6.2	1053093	12.73	3/4" Socket	1192925	1.42
7/8	20-22	LC	8.3	1053100	17.58	7/8" Socket	1192949	1.55
1	24-26	NC	11.0	1053119	31.46	1" Socket	1192961	1.80
1-1/8	28-30	OC **	14.0	1053128	53.73	1-1/8" Socket	1192989	2.05

* Minimum Ultimate Load is 5 times the Working Load Limit.

** ID Code "O" is original 319 style hook.

Wire Rope Size		S-319SWG Stock No.	Dimensions (in.)														
(in.)	(mm)		B	D	E	F	G	H	J	K	L	M	O	P	R	Y	AA
3/16	5	1053002	.44	2.86	.20	.63	.73	.81	.93	.63	5.18	.63	.93	1.96	2.39	2.00	1.50
1/4	6-7	1053011	.50	3.15	.27	.69	.84	.94	.97	.71	5.72	.71	.97	2.22	2.63	2.25	2.00
5/16	8	1053020	.65	3.59	.34	.75	1.00	1.16	1.06	.88	6.39	.88	1.06	2.44	2.80	2.50	2.00
5/16	8	1053039	.77	3.99	.34	.81	1.14	1.31	1.19	.94	7.18	.94	1.16	2.78	3.21	2.75	2.00
3/8	9-10	1053048	.77	3.99	.41	.81	1.14	1.31	1.19	.94	7.18	.94	1.16	2.78	3.21	2.75	2.00
7/16	11	1053057	.98	4.84	.48	1.00	1.44	1.63	1.50	1.31	8.70	1.13	1.41	3.47	3.92	3.25	2.50
1/2	12-13	1053066	.98	4.84	.55	1.00	1.44	1.63	1.50	1.31	8.70	1.13	1.41	3.47	3.92	3.25	2.50
9/16	14-15	1053075	1.25	6.27	.61	1.25	1.82	2.06	1.78	1.66	10.51	1.44	1.69	4.59	4.86	3.75	3.00
5/8	16	1053084	1.25	6.27	.67	1.25	1.82	2.06	1.78	1.66	10.51	1.44	1.69	4.59	4.86	3.75	3.00
3/4	18	1053093	1.55	7.54	.80	1.50	2.26	2.63	2.41	1.88	12.63	1.63	2.22	5.25	6.00	4.25	4.00
7/8	20-22	1053100	1.70	8.33	.94	1.63	2.60	2.94	2.62	2.19	13.60	1.94	2.41	5.69	6.51	4.38	4.00
1	24-26	1053119	1.98	10.38	1.06	2.13	3.01	3.50	3.41	2.69	16.80	2.38	3.19	6.88	8.30	5.38	4.00
1-1/8	28-30	1053128	2.25	13.63	1.19	2.50	3.62	4.62	4.00	3.00	23.09	3.00	3.25	8.78	9.43	9.75	6.50